

M3

Rw.  
SME/BD

1 (VV) (01b) (18)

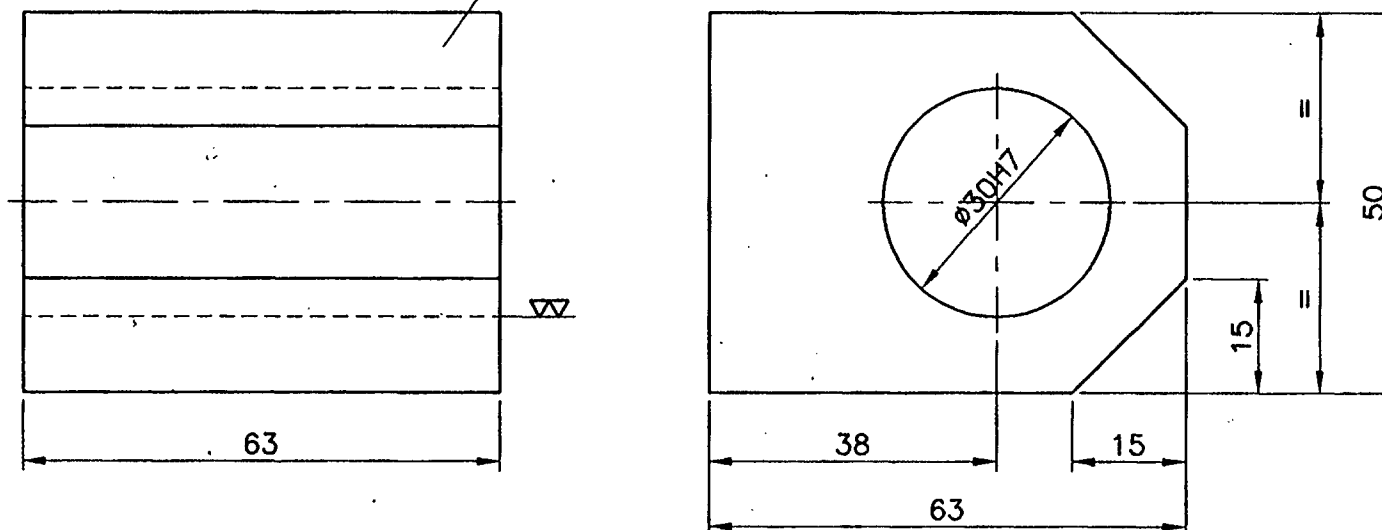

1. FOR UNTOLERANCED DIMENSIONS REFER DRG.NO.  
ICF/STD-9-0-001
2. FINISHED COMPONENT SHALL BE THOROUGHLY CLEANED  
AND PAINTED WITH ONE COAT OF RED OXIDE ZINC CHROMATE  
PRIMER.

[illegible]

FORM IR A3 420 x 300